

AETES

110VDC Inverter 280-560VA

*Pure Sine Wave 50/60Hz Output
DIN-Rail Mountable Design
Three Year Warranty*



"...power alliance..."

Specification

ITEMS	MODEL	ERW-110-1PO-280	ERW-110-1PO-420	ERW-110-1PO-560
Input Voltage Range		90V...135V DC		
Output Voltage		Optional; 100V, 110V, 120V, 220V, 230V, 240V AC		
Output Frequency		Optional; 50Hz or 60Hz		
Output Power Rating (max.)		280VA (280 Watt)	420VA (420 Watt)	560VA (560 Watt)
Output Peak Power Capability		200% for 1 ms at 25 °C		
Output Over Load Protection		>110%		
Input Over Voltage Protection		Yes		
Input Low Voltage Protection		Yes		
Over Temperature Protection		Yes		
Short-Circuit Protection		Yes		
Efficiency Typ. (Full Load)		91%		
Line Regulation (max.)		3%		
Load Regulation (max.)		5%		
THD Linear (max.)		3%		
Input Leakage Current (max.)		100mA		
Output Wave Form		Pure Sine Wave		
Mounting Kit		DIN Rail + Ears Brackets		
Remote ON / OFF		Yes		
Power Good /Alarm Contact		Dry Contact (NO/ NC)		
Status Indicator LED		White: OFF Blue: Ready Green: ON Red: Fault		
Enclosure Material/ Color		Aluminum / Anthracite Grey (RAL7016 Texture)		
Cooling		Internal Fan-Forced		
Operating Temperature		-10 °C to +50 °C		
Storage Temperature		-30 °C to +70 °C		
Humidity (Non Condensing)		20-90% RH operating, 10-95% RH non operating		
Safety Compatibility		EN60950-1		
EMI Compatibility		EN55032 Class B		
Weight (Typ)		3,8 kg	4,6 kg	5,2 kg
Dimensions		A:100 B: 225 C: 240 mm		
Warranty		3-YEAR		

Drawing

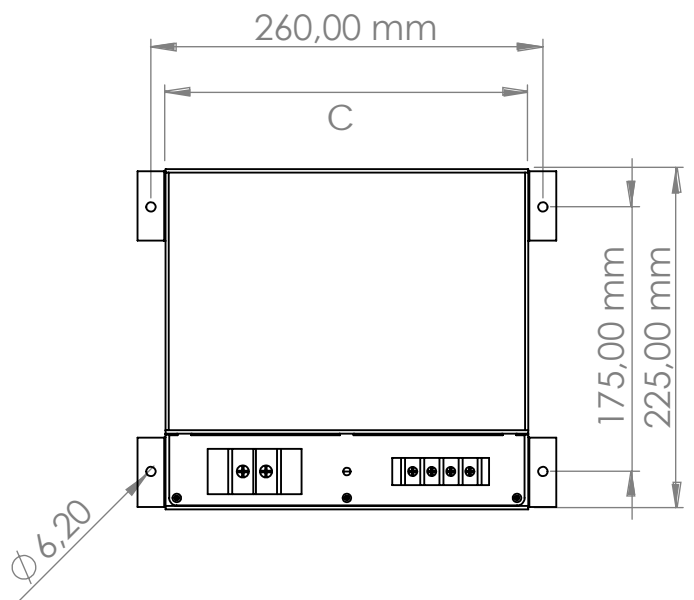
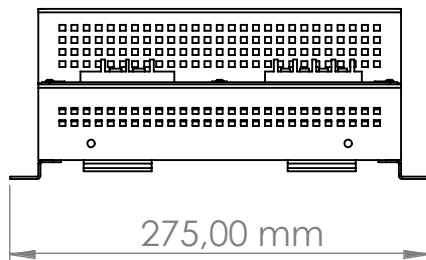
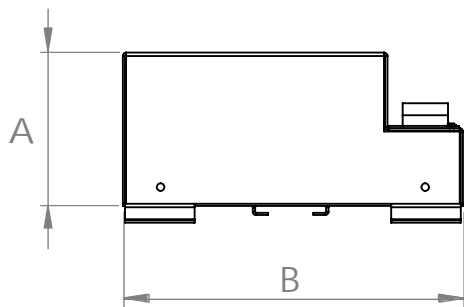
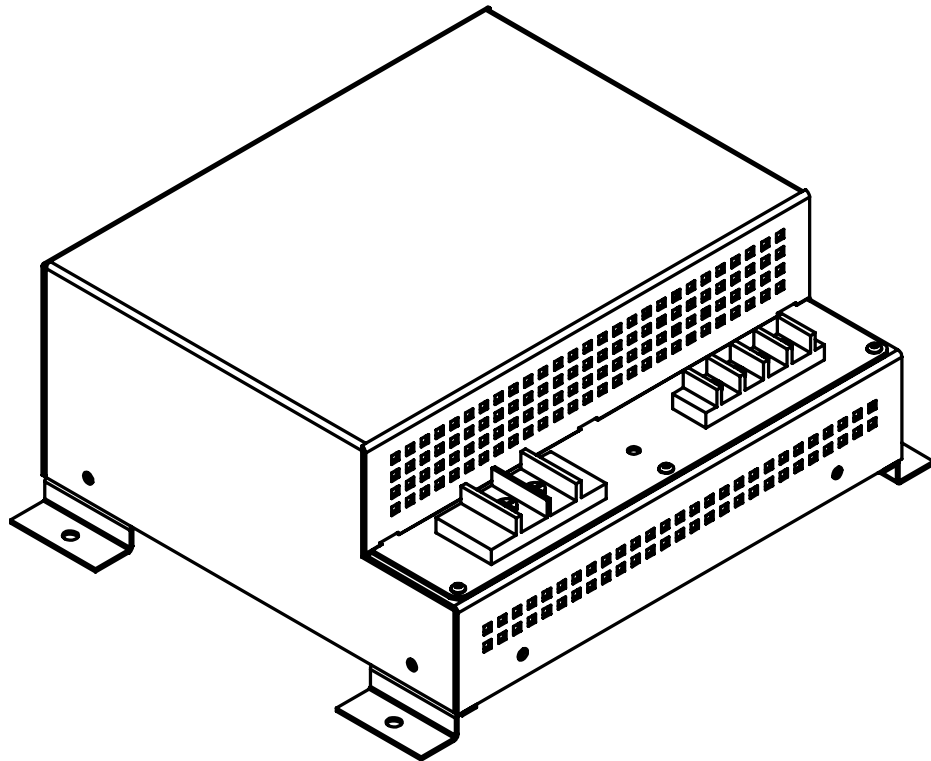

"...power alliance..."

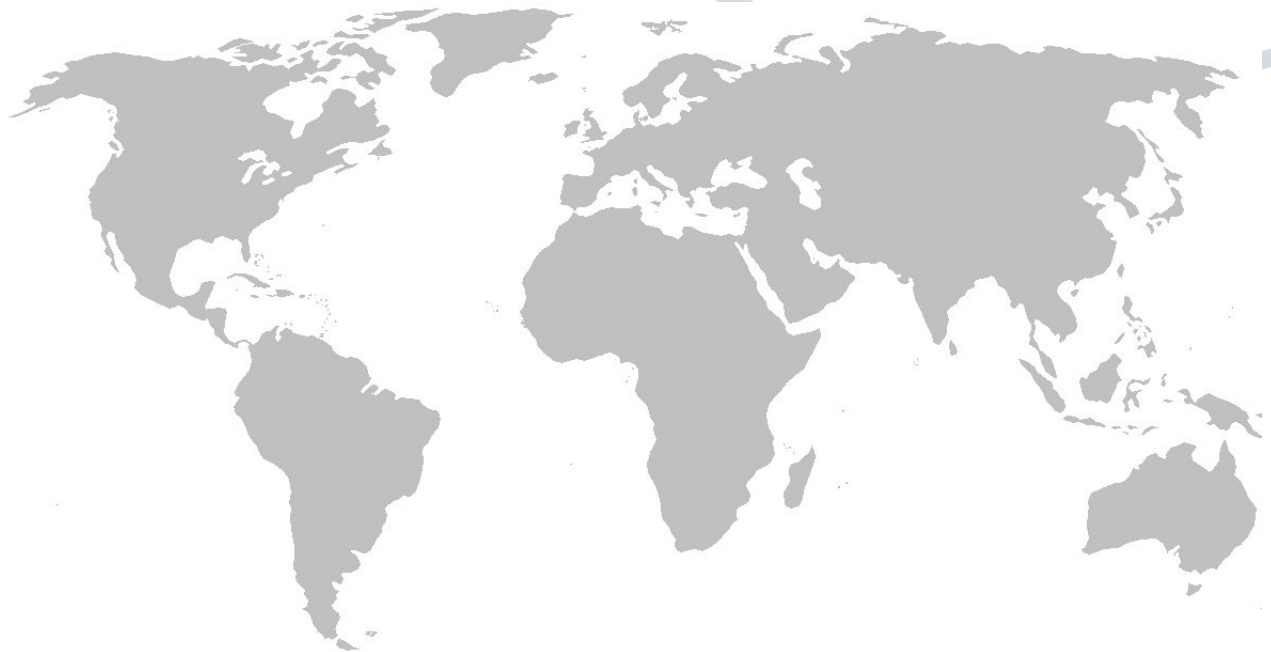

AETES
"...power alliance..."

The specifications, drawings and images indicated in this document are based on current information. All content is subject to modifications or additions. For more information on our local sales offices, visit us at our website below.