

AETES

48V DC POWER SUPPLY

DIN Rail and Panel Mountable
Wide Temperature Range
Industrial Grade Design



"...power alliance..."

Specification

	MODEL	230-48-600W	230-48-1200W
ITEMS			
Input Voltage Range		86V ... 264V AC (47 ... 63Hz)	
Max. Input Current (230V AC)		3.8A	8.2A
Output Voltage		48V DC	48V DC
Max. Output Current (DC)		12A (600 Watt)	25A (1200 Watt)
Power Factor		0.9 (Meets EN61000-3-2 Class A)	
Overcurrent Protection		>105% Constant current style	
Overvoltage Protection		125% -140%	
Over temperature Protection		Yes	
Hold Up Time (Typ)		20ms at 115V /230V AC	
Efficiency (230VAC)		88%	80%
Load Regulation (max.)		384 mV	
Line Regulation (max.)		192 mV	
Ripple Noise (max.)		200 mV	
Remote On/Off		Optionally	
Panel Mounting Kit		Included	
DC OK Signal		Optionally	
Enclosure Color		Anthracite Grey (RAL7016 Texture)	
Operating Temperature		-10°C to 70°C, derating linearly to 50% load above 50°C	
Storage Temperature		-30°C to +75°C	
Humidity (non condensing)		30 - 90% RH operating, 10 - 90% RH non operating	
Cooling		Internal fan	
Withstand Voltage (One minute)		Input to Ground 2kVAC, Input to Output 3kVAC, Output to Ground 500VAC	
Isolation Resistance		>100MΩ at 25°C & 70%RH, Output to Ground 500VDC	
Vibration Compatibility		MIL-STD-810F 514.5 CAT. 4,10	
Shock Compatibility		<196.1 m/s ²	
Immunity Compatibility		EN61000-4 -2 -3 -4 -5 -6 -8 -11	
Safety Compatibility		EN60950-1	
EMI Compatibility		EN55011 / EN55022-B, FCC Class B	
Weight (Typ)		3,5 kg	5,6 kg
Dimensions		A: 100 B: 225 C: 240 mm	A: 120 B: 225 C: 240 mm
Warranty		3 yrs	

Drawing

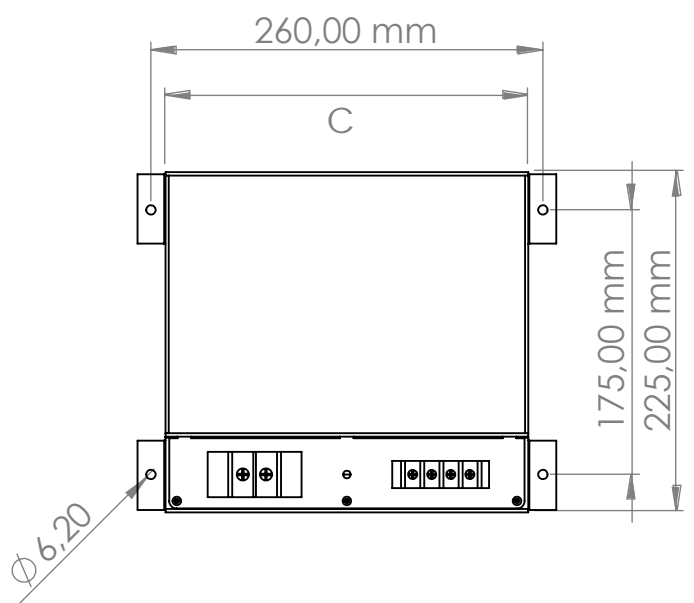
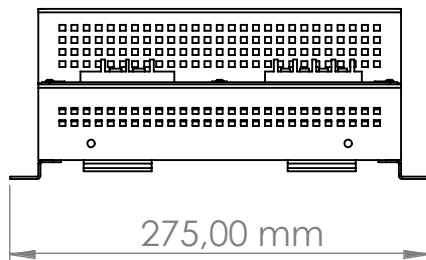
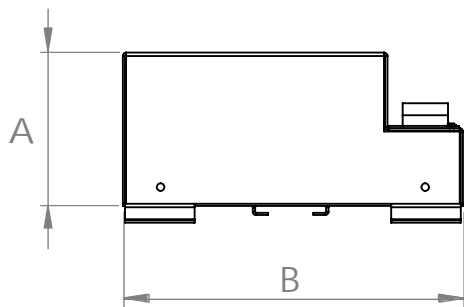
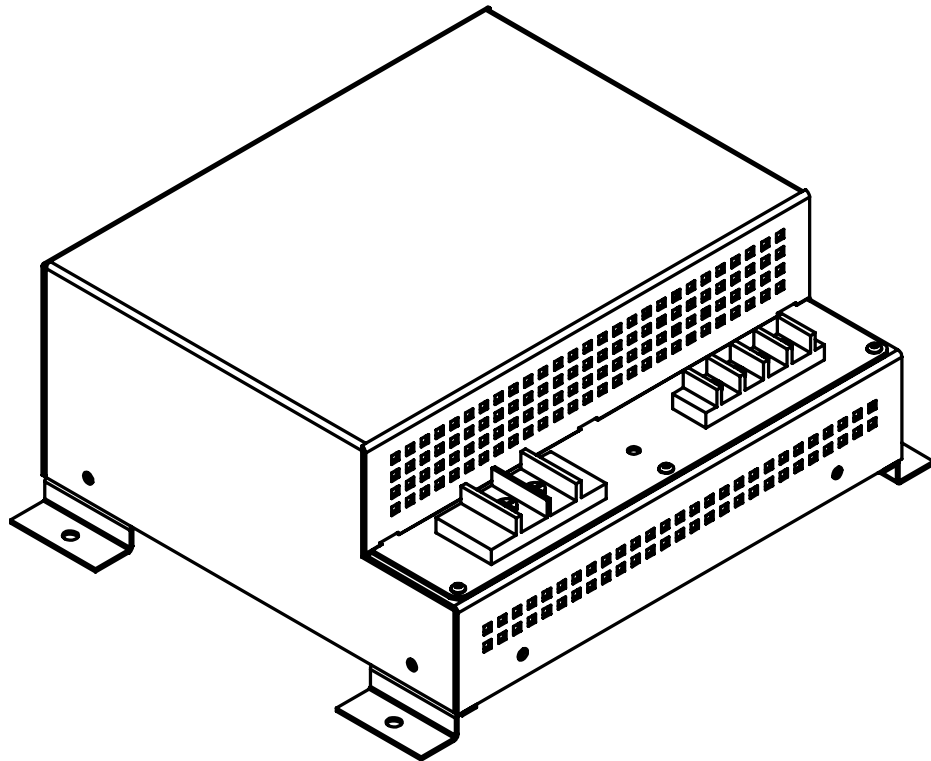

"...power alliance..."

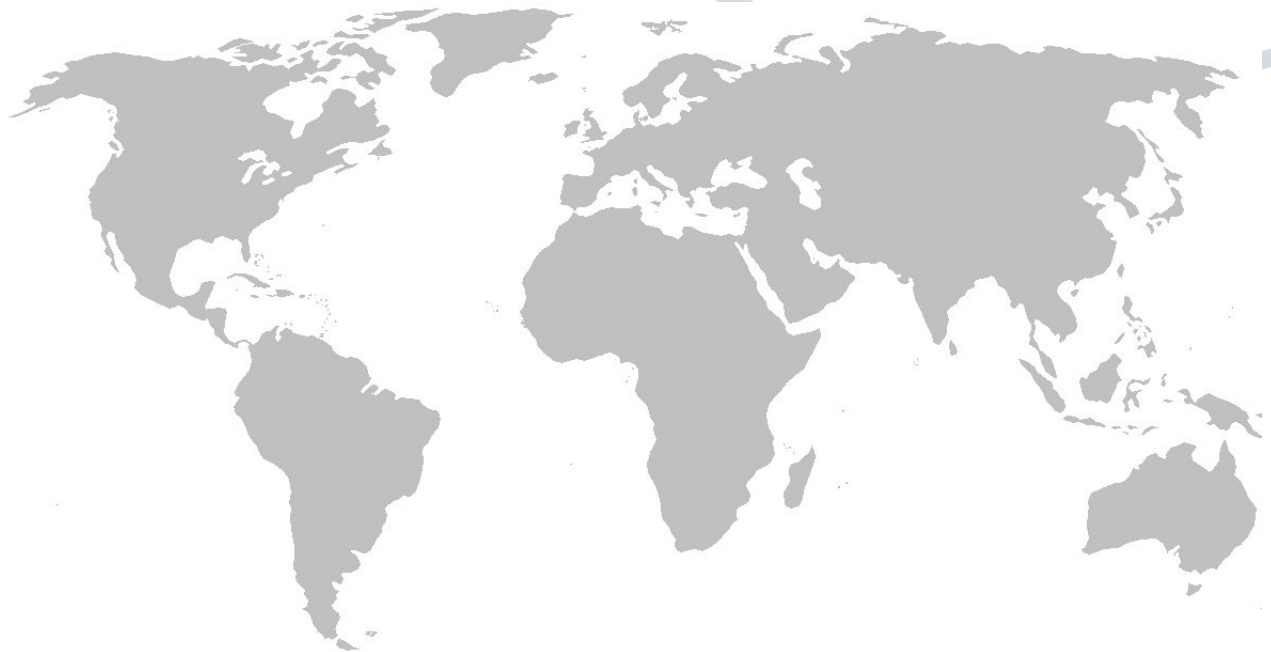

AETES
"...power alliance..."

The specifications, drawings and images indicated in this document are based on current information. All content is subject to modifications or additions. For more information on our local sales offices, visit us at our website below.