

# AETES

## 600V DC CONVERTER 8A

*DIN Rail and Panel Mountable*  
*Wide Temperature Range*  
*Industrial Grade Design*



*"...power alliance..."*

## Specification

| ITEMS                       | MODEL | 600-24-08A-DN   | 600-28-08A-DN | 600-48-08A-DN |
|-----------------------------|-------|---|---------------|---------------|
| Input Voltage Range         | -     | 600V DC (350V... 850V DC)   |               |               |
| Output Voltage              | -     | 24VDC   | 28VDC         | 48VDC         |
| Input Current (600VDC )     | -     | 0.5A  | 0.7A          | 0.9A          |
| Max. Output Current (DC)    | -     | 8A (200 Watt)   | 8A (300 Watt) | 8A (400 Watt) |
| Cooling                     | -     | Natural   |               |               |
| Over Current Protection     | -     | >105%, Constant current style   |               |               |
| Over Voltage Protection     | V     | 125% -140%  |               |               |
| Over Temperature Protection | -     | Yes   |               |               |
| Hold Up Time (Typ)          | ms    | 12ms at 600VDC  |               |               |
| Efficiency( 600VDC )        | %     | 87  |               |               |
| Load Regulation (max.)Line  | %     | 2.0   |               |               |
| Regulation (max.)           | %     | 0.5   |               |               |
| Ripple Noise (max.)         | mV    | 200   |               |               |
| Panel Mounting Kit          | -     | Included  |               |               |
| Dual Output                 | -     | (12V+28V or 24V+48V etc.) Optionally                                    |               |               |
| Customized Output Voltage   | -     | (12V...15V / 25V..30V / 52V...56V / 90V...100V) Optionally              |               |               |
| Enclosure Color             | -     | Anthracite Grey (RAL7016 Texture)                                       |               |               |
| Operating Temperature       | -     | -25°C to 70°C, derating linearly to 50% load above 50°C                 |               |               |
| Storage Temperature         | -     | -40°C to +75°C  |               |               |
| Humidity(non condensing)    | -     | 30 - 90% RH operating, 10 - 90%RH non operating                         |               |               |
| Withstand Voltage (1 min)   | -     | Input to Ground 2kV AC, Input to Output 3kV AC, Output to Ground 2KV DC |               |               |
| MTBF                        | -     | MIL-HDBK-217F@25°C≥ 300,000 h   |               |               |
| Case Material               | -     | Aluminum  |               |               |
| Isolation Resistance        | -     | >100MΩ at 25°C & 70%RH, Output to Ground 500VDC                         |               |               |
| Vibration Compatibility     | -     | MIL-STD-810F 514.5 CAT. 4, 10   |               |               |
| Shock Compatibility         | -     | <196.1 m/s <sup>2</sup>   |               |               |
| Immunity Compatibility      | -     | EN61000-4 -2 -3 -4 -5 -6  |               |               |
| Safety Compatibility        | -     | EN62109   |               |               |
| EMI Compatibility           | -     | EN55032 FCC Class A   |               |               |
| Weight (Typ)                | -     | 2,2 kg  | 3,3 kg        | 3,3 kg        |
| Size ( D x H x W )          | mm    | 100 x 225 x 240   |               |               |
| Warranty                    | yrs   | 3   |               |               |

# Drawing

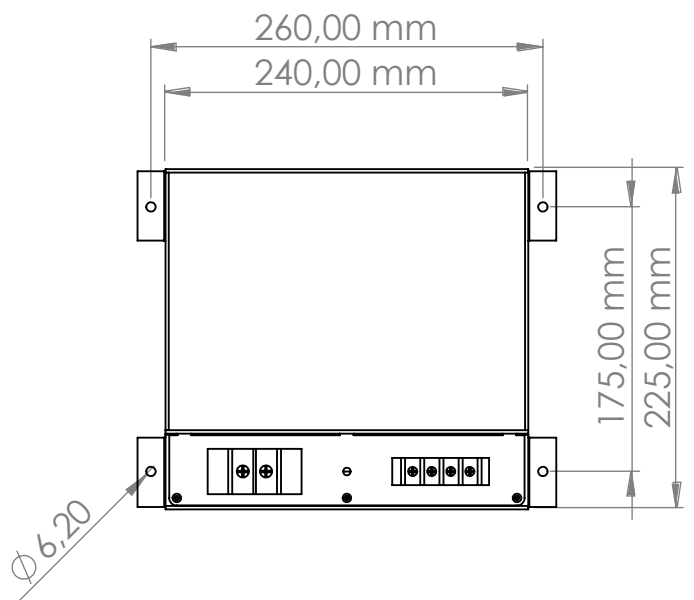
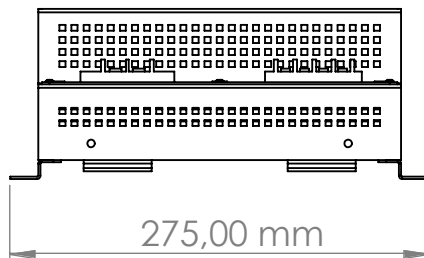
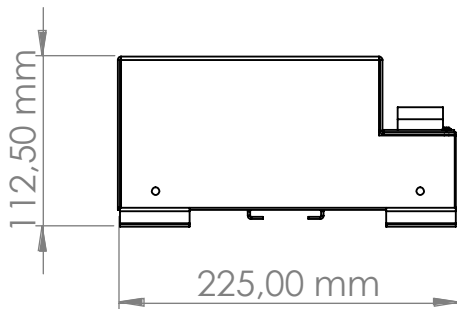
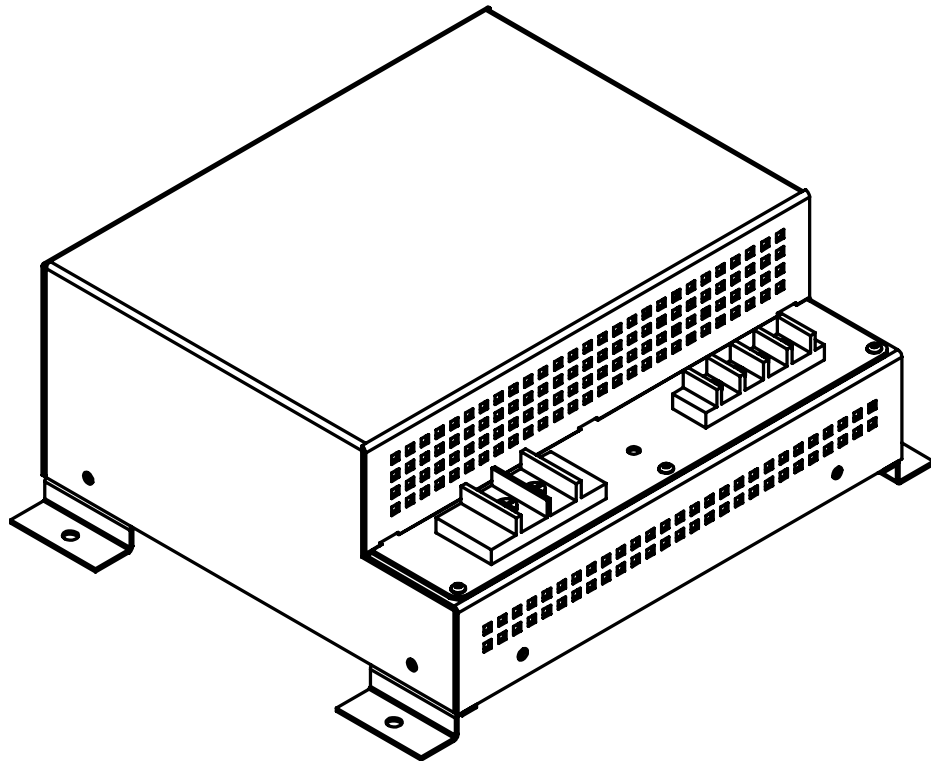

*"...power alliance..."*

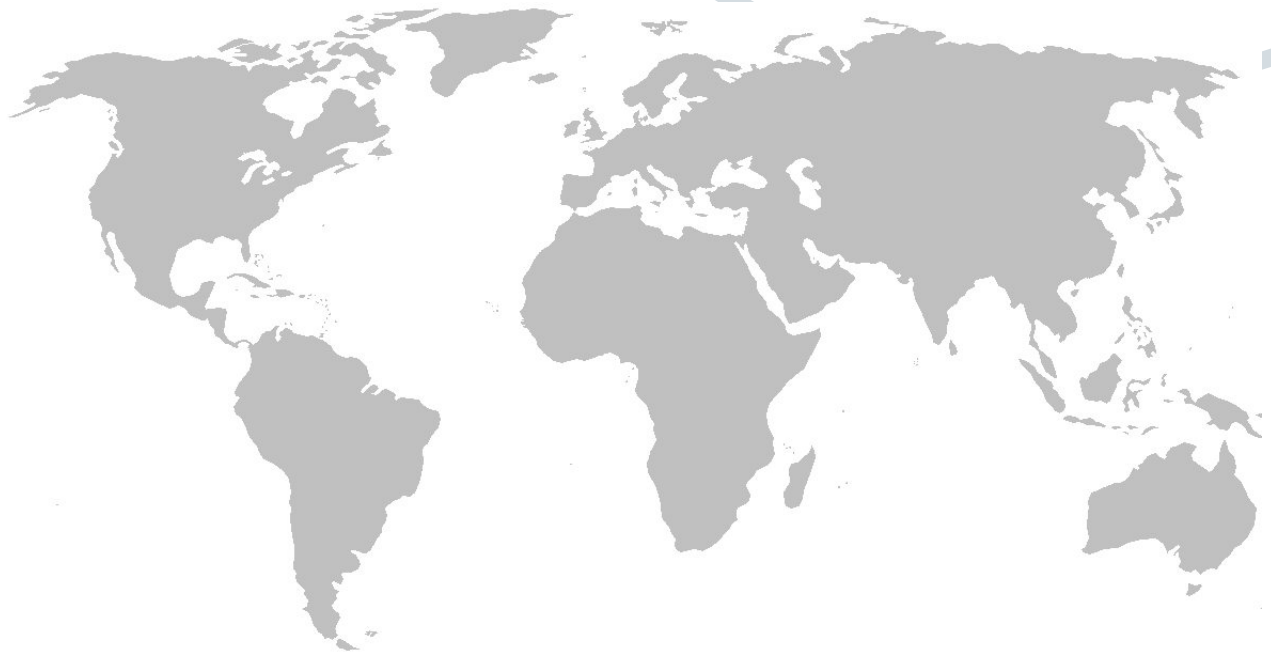

**AETES**  
*"...power alliance..."*

The specifications, drawings and images indicated in this document are based on current information. All content is subject to modifications or additions. For more information on our local sales offices, visit us at our website below.