

AETES

750V DC/DC Converter 200W

-40°C to +70°C Operating Range

DIN-Rail and Panel Mountable

Lightweight Aluminum Case



"...power alliance..."

Specification

ITEMS	MODEL	CRW-750-24-200	CRW-750-48-200
Input Voltage Range		750VDC (500V...1000V DC)	
Output Power Rating		200 Watt	
Output Voltage		24VDC	48VDC
Max. Output Current (DC)		8 Amp	4 Amp
Input Reverse Polarity Protection		Yes	
Over Current Protection		>110% (Auto-recovery)	
Over Voltage Protection		Yes	
Output Short Circuit Protection		Yes (Auto-recovery)	
Hold Up Time (Typ.)		12ms at 750VDC	
Efficiency (Typ.)		87%	
Load Regulation (0%-100% load))		±2.0%	
Line Regulation (max.)		±0.5%	
Ripple Noise (max.)		200mV	
Output Voltage Accuracy		±2.0%	
Switching Frequency		65 kHz	
Temperature Coefficient		±0.02% /°C	
Operating Temperature		-40°C to +70°C, derating linearly to 50% load above +50°C	
Storage Temperature		-40°C to +85°C	
Humidity (non condensing)		10-95%RH non operating	
Cooling		Free Air Convection	
Enclosure Color		Anthracite Grey (RAL7016 Texture)	
Case Material		Aluminum	
Mounting Accessories		Mounting Feet and DIN Rail Kit	
Vibration and Shock Compatibility		EN61373 - Category 1, Class B	
MTBF		MIL-HDBK-217F@25°C ≥ 300,000 h	
Isolation (1 min.)		Input to Ground 2kV AC, Input to Output 4kV AC, Output to Ground 2kV DC	
Immunity Compatibility		EN61000-4 -2 /-3 /-4 /-5 /-6	
Safety Compatibility		EN62109-1	
EMI Compatibility		EN55032 FCC Class A	
Weight (Typ.)		2,2 kg	
Size (D x H x W)		100 x 225 x 240 mm	
Warranty		3-YEAR	

Drawing

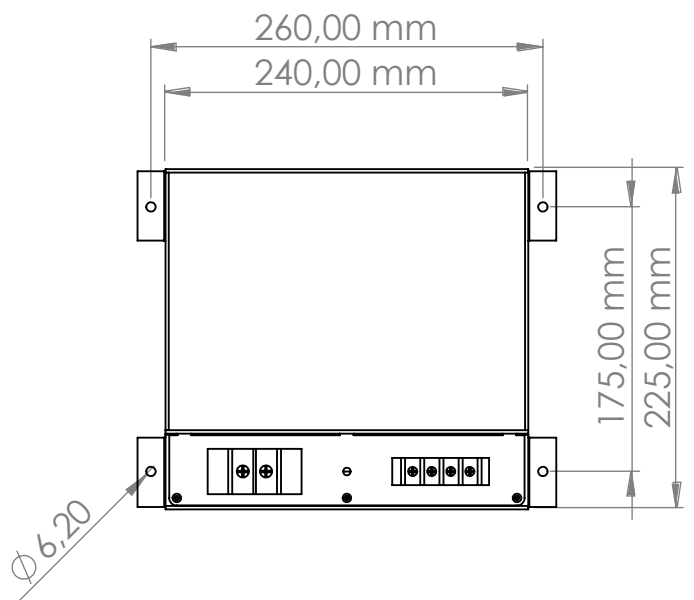
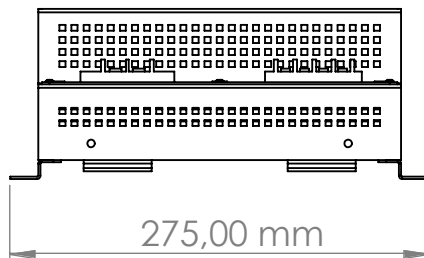
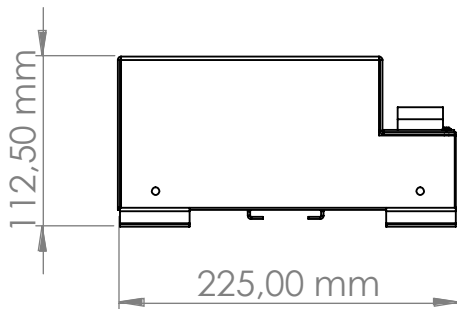
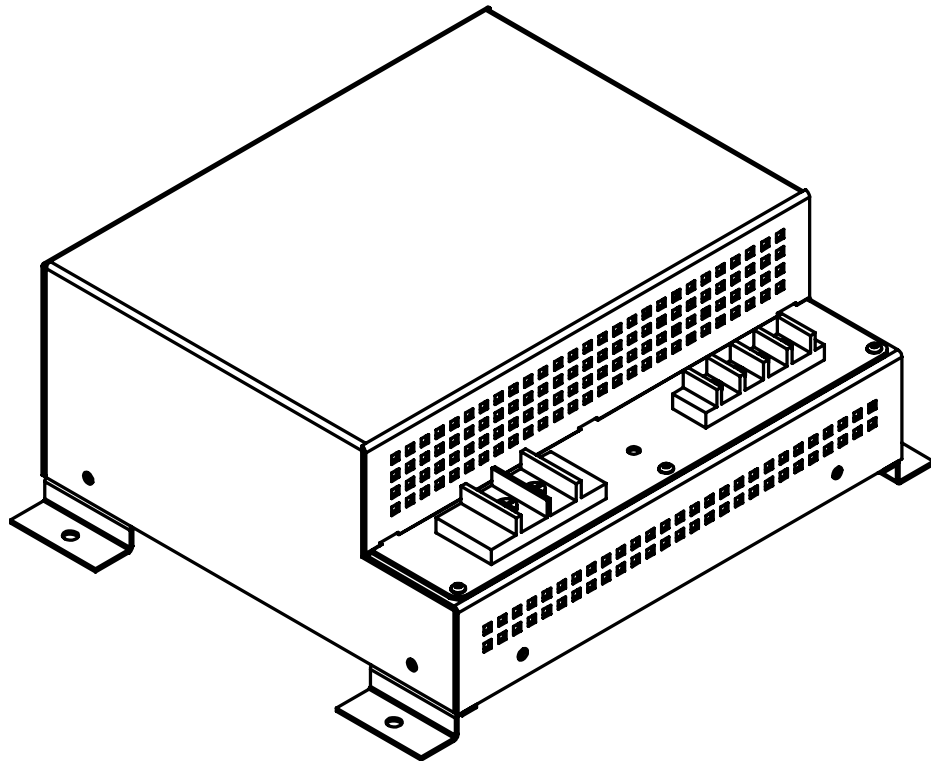

"...power alliance..."

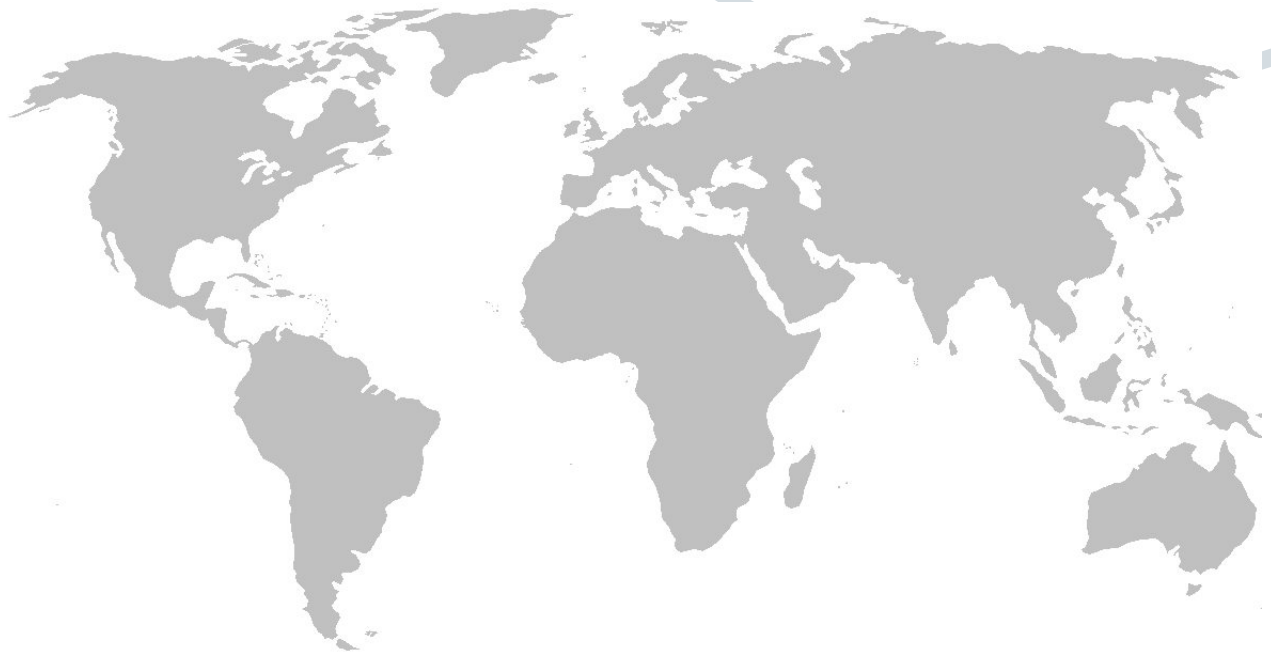

AETES
"...power alliance..."

The specifications, drawings and images indicated in this document are based on current information. All content is subject to modifications or additions. For more information on our local sales offices, visit us at our website below.